



PRO 0201IP 2 Routes Light Switch User's Manual

Product Specification

PRO 0201IP is a 2 Routes Light Switch . It is accorded with the base protocol of IEEE 802.15.4, and be suitable for smart home design system which is structured by ZigBee network. Through (TCP/IP)/(ZigBee) gateway, it can realize the Local real-time control, o the lights.

Functions Features

1. ZigBee networky protocol for flexible networking.
2. Use Null & Fire line's way to supply power, which made the working system more stability.
3. Have 2 road relay driver, which can replace the mechanical panel to realize the Local control.
4. Can cooperate with ZigBee network coordinator (gateway), it can realize the remote control by MP, PAD or PC.
5. 2-zone lights monitor button, it can separately binding

- 5-way lights, and realize the function of all turn on/off
- 9.Flexible scene configuration mode, which can be configured by software or offline.
- 10.With function of synchronize indicate scene status
11. 5mm Capacitive Touch white tempered glass Panel
- 12.86-box installation method.

1

Technical Specification

Operating Voltage	AC90~250V, 50/60Hz
Power Consumption	Standby: Max 1W Running: Max 3W
Load Power	One road: incandescent lamp Max1000W energy saving lamp/fluorescent lamp Max 200W Multi road: incandescent lamp Max1500W energy saving lamp/fluorescent lamp Max 400W
Operating Temperature	-10℃~+50℃
Operating Humidity	35%~85%RH
Wireless Communication Protocol	IEEE 802. 15. 4 (ZigBee Pro)
Wireless Transmit Power	4. 5dBm
Wireless Receiving Sensitivity	-94dBm
Dimension	86mm*85mm*35mm
Installation Method	86 bottom case (least depth55mm)

Layout

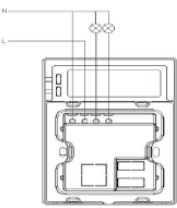
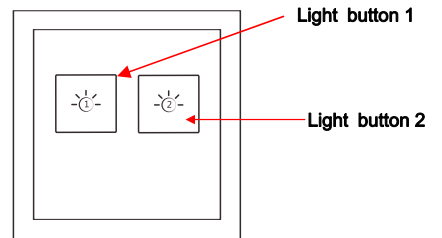

Wiring diagram

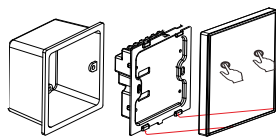

Note: Put the buckle on the lower part of the panel into ingroove, then fasten the upper part, press the buckle on the upper part of the panel, it will completely stuck.

Installation diagram

Operation

1. Network Entry

If you want to realize the remote control, first you must add it to the network which is structured by ZigBee network coordinator as follows:

To set ZigBee network coordinator on the status that allowing to add other equipments;

Press the **Reset** and **Set** button on the side of centralized control panel at the same time, release the **Reset** button, and then release the **Set** button. if the indicator flash once and then flash 5 times,it means it is successful to access network, otherwise it is failed.

2

2. Manual Control

2.1. Panel button Control

Local light control: press **Light button 1~2**, it can control the light's on or off. It means the light is on when the indicator is on, otherwise it is off.

2.2. Reset to the factory

Long press the **Set** button on the side of the panel 8 seconds until you hear a long beep, the centralized control panel will reset to the factory and clear all scenes and binding information.

3. Configuration and debugging of the extension

3.1. The extension network configuration

Select "Cloud Control" on the digital extension, then enter the interface, choose **[:] - Start to Register** ;

Press the **Reset** and **Set** button on the side of centralized control panel at the same time, release the **Reset** button first, then release the **Set** button, if centralized control panel's indicator flash once and then 5 times, it means it is successful to access network, otherwise it is failed, please repeat the above operation.

When finish to networking, select the "Cloud Control" on the digital extension, then enter the interface, choose **[:] - Finish Register**.

3.2. The extension blinding settings

Select "Cloud Control" on the digital extension, then enter the interface, choose **[:] - Start to Register**;

Select "Cloud Control" on the digital extension, then enter the interface, select "The Lights Control" to enter the relative interface, first to press the requested register's light icon, then press the relative function button on the centralized control panel, then it is finished; as to other button's registration, please repeat the above operation.

When all are finished, choose "cloud control" on the digital extension, then enter the interface, choose **[:] - Finish Register**.

3.3. the debugging of extension binding

Press the blinding light icon of the room, you can debugging the binding is successful or not; if the blinding is invalid, repeat the above operation.

3

4

5